

HIMACS Nebula creates architectural impact in Dublin's new Garda HQ



HIMACS in Nebula was selected to clad the atrium stair balustrades and handrails in the new Garda Síochána HQ in Dublin

HI·MACS

Modern, spacious, state-of-the-art and practical, Walter Scott House is the new Garda Síochána headquarters that has opened its doors at Military Road, Dublin 8. A two-year project commissioned in 2020 by the Office of Public Works, the new Garda HQ is occupied by up to 900 Garda personnel, who benefit from its impressive structural and architectural features that include HIMACS in Nebula for the cladding of its central atrium stair balustrades and handrails.

The building is named after Colonel Walter Scott, an Honorary Commissioner of the New York City Police, who presented the Garda Síochána with a \$1,000 gold bond 100 years ago. That bond would go on to sponsor the Walter Scott Medal for Valor and is the highest accolade that a member of the Garda Síochána can achieve for acts of bravery. The cutting-edge headquarters will house numerous bureaus and investigation teams and was commissioned by the Office of Public Works.

This new police headquarters was made possible by the collaboration of John Paul Construction, Solid Fabrications and James Latham Solid Surface. HIMACS in Nebula was selected for cladding the internal facing of the extensive system of walkways and stair balustrades over three floors and includes an alcove for the handrail and a top cap.

Marc Beattie, Managing Director of Solid Fabrications comments: 'We are proud to have worked on this demanding project and we feel that HIMACS was a great solution in terms of workability, durability and also how it compliments this contemporary aesthetic'.

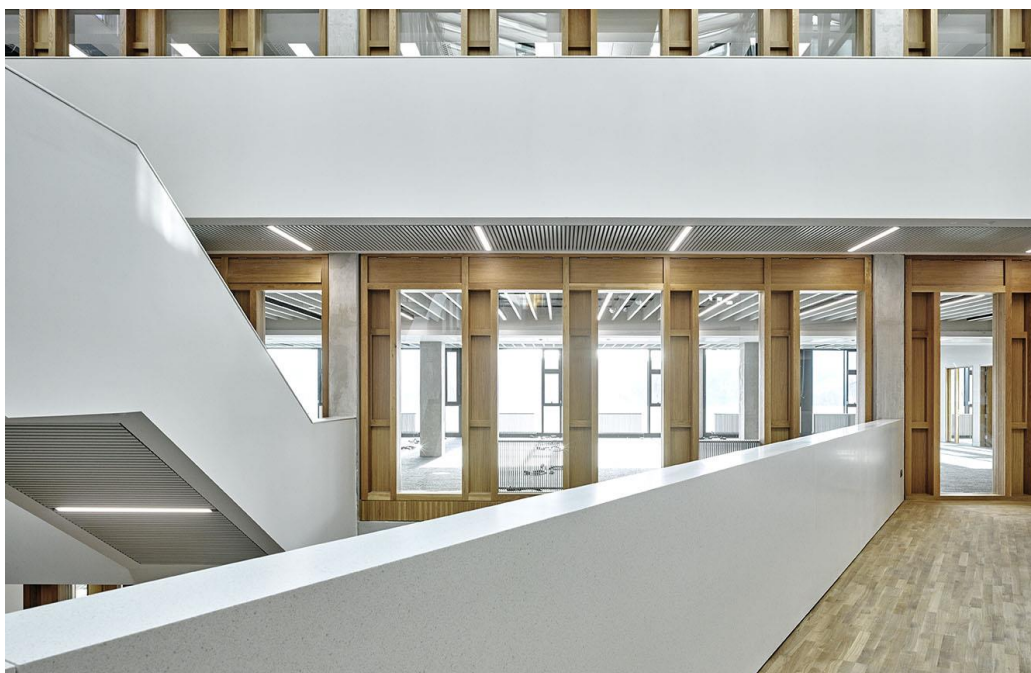

HI·MACS



HI·MACS

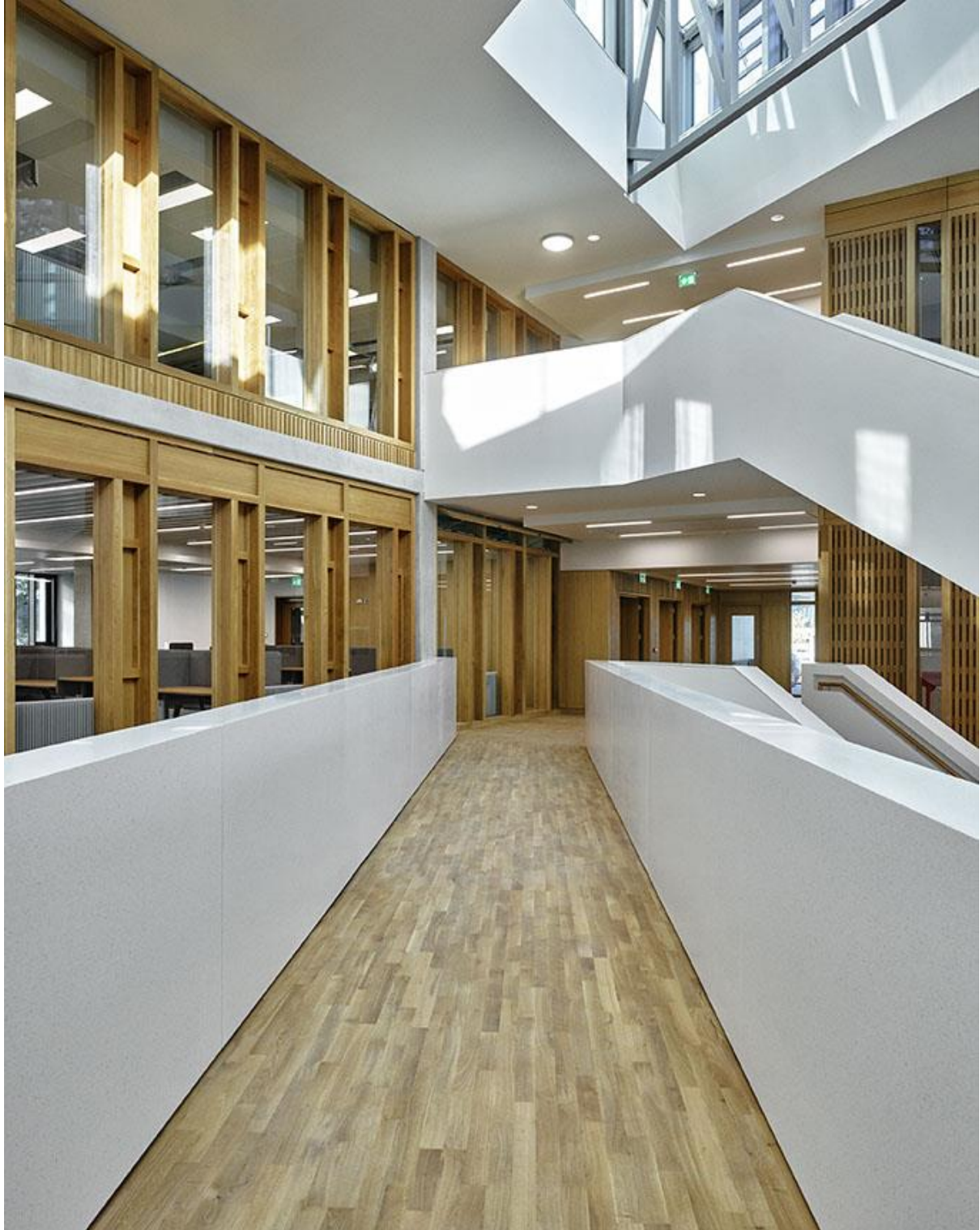

Part of the Aster Collection, HIMACS Nebula T010 is a 12mm thick solid surface material suitable for every indoor use, for commercial, residential and public spaces. Robust, durable, hardwearing and fire resistant, it's the perfect choice for offices, headquarters, business premises and residential projects alike. It's also extremely hygienic and resistant to wear and tear, scratches, stains and UV rays while its non-porous surface also makes it extremely quick and easy to clean. The thermoformable properties of HIMACS also allow this material to be

HI·MACS

moulded into any shape and size. The results achieve a smooth and seamless surface thanks to the absence of visible seams, which also has the benefit of preventing the build up of dirt, bacteria and viruses. This makes HIMACS a Solid Surface material with unbeatable hygienic properties, guaranteed by certifications that comply with LGA and NSF international standard.

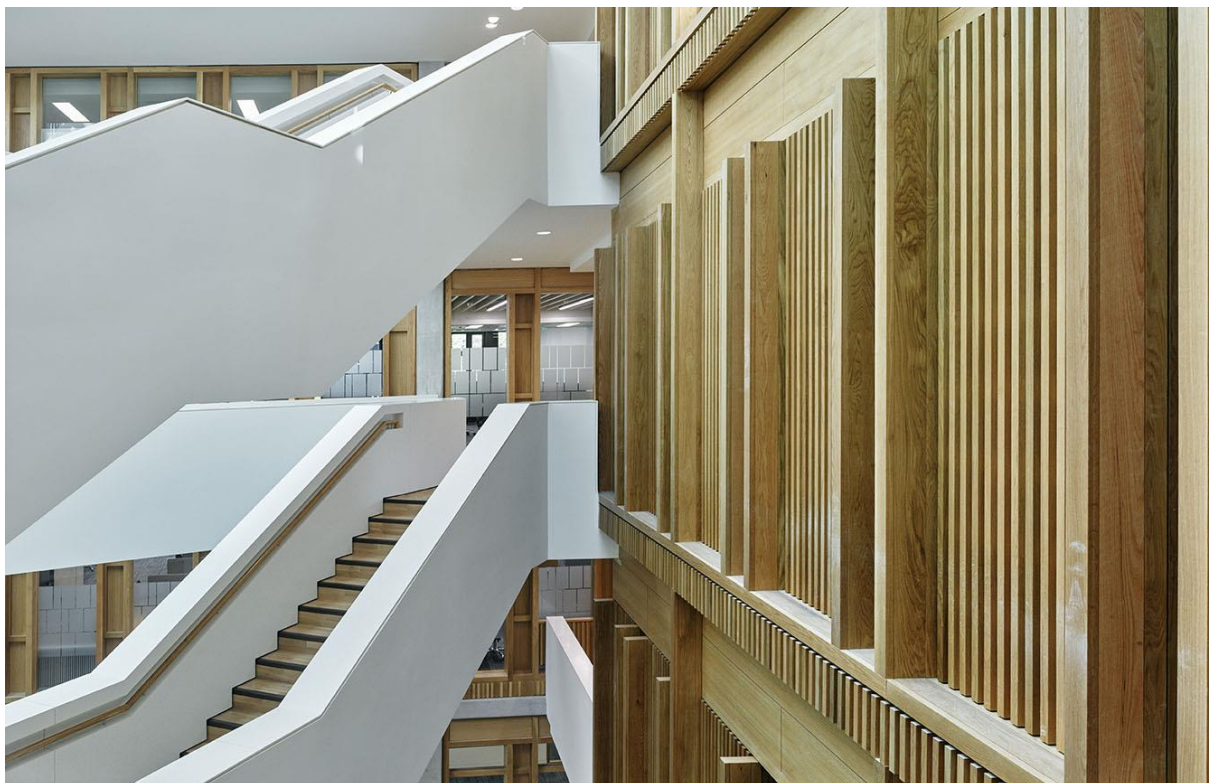

HI·MACS

INFORMATION ABOUT THE PROJECT DESIGN

Project name: Garda HQ

Location: Dublin, Ireland

Designer: Office of Public Works

Fabricator: Solid Fabrications www.solidfabrications.co.uk

HIMACS supplier: James Latham

Construction: John Paul Construction

Material: HIMACS Nebula T010 www.lxhausys.com/eu/himacs

HIMACS elements: Atrium stair balustrades and handrails

Photos: Marie-Louise Halpenny

HIMACS. Because Quality Wins

About HIMACS Solid Surface

www.lxhausys.com/eu/himacs

HIMACS is a solid surface material that can be moulded into any shape. It is widely used for architectural and interior applications, such as sculptural and high-performance wall cladding or kitchen, bathroom and furniture surfaces, in commercial, residential and public space projects. It is composed of minerals, acrylic and natural pigments that come together to provide a smooth, non-porous and visually seamless surface which meets the highest standards for quality, aesthetics, fabrication, functionality and hygiene – offering many advantages over conventional materials.

HIMACS provides limitless possibilities for surfacing solutions and inspires creative minds from all over the world. **Zaha Hadid, Jean Nouvel, Rafael Moneo, Karim Rashid, Marcel Wanders** and **David Chipperfield**, among others, have completed fabulous projects using HIMACS.

At the forefront of innovation as always, LX Hausys recently introduced two new products. First, **HIMACS Ultra-Thermoforming**, an innovative formula that pushes the boundaries of solid surface shaping to a whole new level, with 30% more thermoplastic capabilities - the biggest innovation in the history of Solid Surface since its inception in 1967. And now, **HIMACS Intense Ultra** combines the characteristics from two disparate worlds: **Intense Colour Technology** and **Ultra-Thermoforming**.

HIMACS uses a simple heating process to give three-dimensional thermoplastic forming capabilities, allows visually seamless designs, offers a virtually limitless range of colours and – for some shades – exhibits a special translucency when exposed to light. Although HIMACS is almost as robust as stone, it can be worked in a similar way as wood: it can be sawn, routed, drilled or sanded.

HIMACS is made using a next-generation technology, the **thermal cure**. The temperature reached during the manufacturing process sets HIMACS apart from other solid surfaces and creates a denser surface that is even sturdier, more homogeneous and more durable, and with better resistance and superior thermoforming results.

HIMACS does not absorb humidity, is highly resistant to stains and is easy to clean, maintain and repair.

Countless internationally recognized certificates attest to the quality of HIMACS in terms of ecological commitment, hygiene and fire resistance – being the first Solid Surface in the market to receive the official **European Technical Approval (ETA) for façades** – for the Alpine White S728 colour.

HIMACS offers a 15-year warranty for products fabricated by a Quality Club Member.



HIMACS. Because Quality Wins.

For more information and to stay connected, visit our [EU WEBSITE](#), [UK WEBSITE](#) and our [newsroom](#).

Let's connect!



* **HIMACS** is designed and produced by **LX Hausys (formerly LG Hausys)**, a world leader in the technology sector and a subsidiary of LX Holdings Corp.